

2

1

## Coupling Cat 7 PVC Pressure 25mm

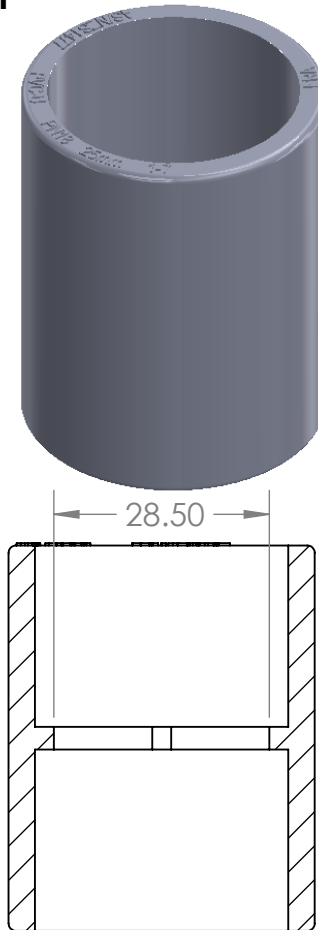
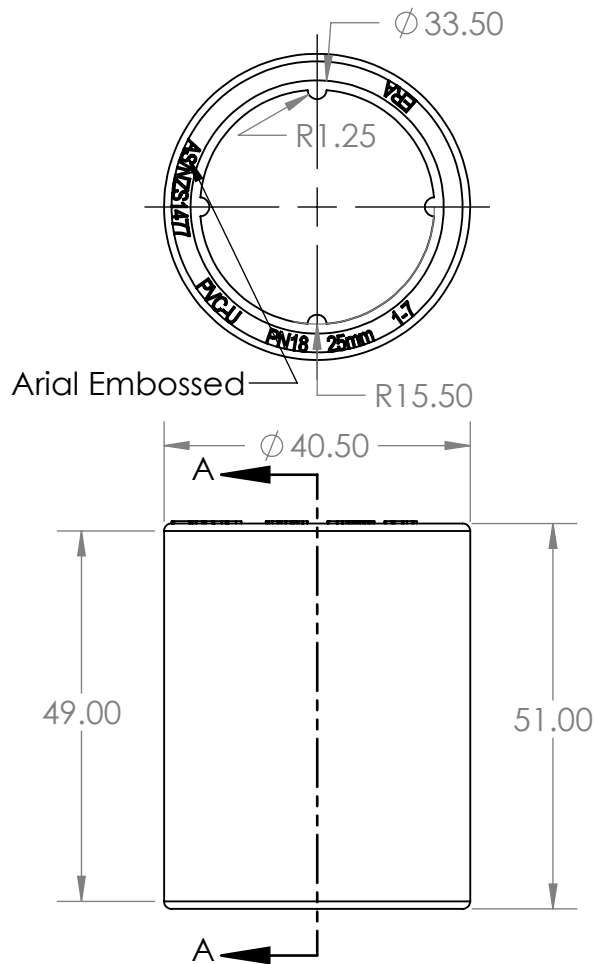

SECTION A-A

### Description

Pressure fittings are used for a large variety of high-pressure water applications. Including irrigation and water reticulation. Aztec PVC Pressure fittings comply with AS/NZS 1477.

- Comply with AS/NZS 1477
- WaterMark certified
- Comply with AS/NZS 4020 for drinking water application
- BEP – PVC certified
- Pressure ratings: PN18 ( $\leq$  DN50), PN15 ( $>$  DN50)
- Joint types: Solvent Cement Joint (SCJ) or Threaded (BSP)
- Size range: DN15 – DN150
- Working temperature: 0°C – 50°C
- Colour: White



#### PROPRIETARY AND CONFIDENTIAL

THE INFORMATION CONTAINED IN THIS DRAWING IS THE SOLE PROPERTY OF AZTEC AUSTRALASIA. ANY REPRODUCTION IN PART OR AS A WHOLE WITHOUT THE WRITTEN PERMISSION OF AZTEC AUSTRALASIA IS PROHIBITED.

|             |         |                                      |  |           |      |                                 |  |
|-------------|---------|--------------------------------------|--|-----------|------|---------------------------------|--|
|             |         | UNLESS OTHERWISE SPECIFIED:          |  | NAME      | DATE | TITLE:                          |  |
|             |         | DIMENSIONS ARE IN INCHES             |  | DRAWN     |      |                                 |  |
|             |         | TOLERANCES:                          |  | CHECKED   |      |                                 |  |
|             |         | FRACTIONAL $\pm$                     |  | ENG APPR. |      |                                 |  |
|             |         | ANGULAR: MACH $\pm$ BEND $\pm$       |  | MFG APPR. |      |                                 |  |
|             |         | TWO PLACE DECIMAL $\pm$              |  | Q.A.      |      | SIZE DWG. NO. REV               |  |
|             |         | THREE PLACE DECIMAL $\pm$            |  | COMMENTS: |      |                                 |  |
|             |         | INTERPRET GEOMETRIC TOLERANCING PER: |  |           |      | A PF725                         |  |
|             |         | MATERIAL                             |  |           |      |                                 |  |
|             |         | FINISH                               |  |           |      | SCALE: 1:1 WEIGHT: SHEET 1 OF 1 |  |
|             |         |                                      |  |           |      |                                 |  |
| NEXT ASSY   | USED ON | FINISH                               |  |           |      |                                 |  |
| APPLICATION |         | DO NOT SCALE DRAWING                 |  |           |      |                                 |  |

2

1