

## Aztec Shear Banded Coupling 175-200mm

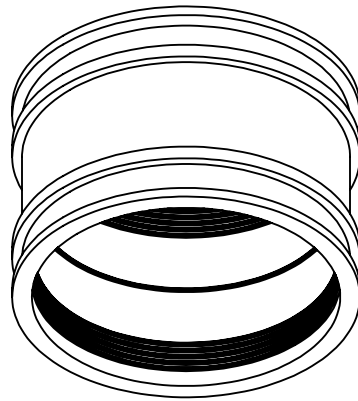
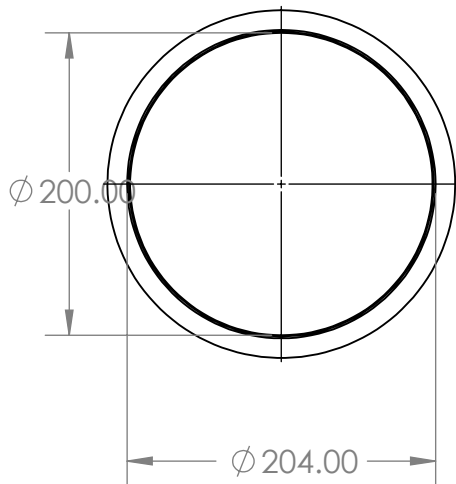
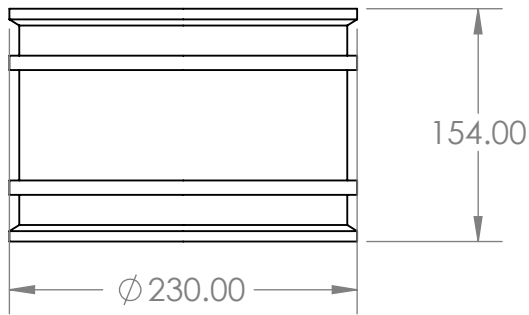

### QnA

- Q. What is the use of the flexible connector?  
A. For the joining of applications of pipes below and above ground. Flexible connectors are suitable for low pressure drainage systems.
- Q. What is Aztec's Aussie Connectors pipe range?  
A. 32mm – 300mm
- Q. Are these suitable for potable water?  
A. Testing is not a requirement under the current watermark certificate. Aussie Connectors are not advised to be used on potable waterlines.
- Q. What is the pipe suitability?  
A. PVC, Copper, Galvanised Steel, Cast Iron.

### Description

Aztec now has a range of Shielded Couplings designed for robust Aussie conditions. Specifically designed for the connection or the repair of pipes on sewer and drainage lines.

The additional stainless-steel wrap around coupling supports the middle section, allowing the pipes to stay aligned and ensure minimal pipe displacement in robust conditions.

- Additional wrap around stainless steel coupling to withstand robust conditions
- Withstands an internal pressure of up to 1 bar
- Stainless steel shielded band prevents pipe displacement
- Complies with AS/NZS 4327-1995
- WaterMark® approved
- Wasa Approved



#### PROPRIETARY AND CONFIDENTIAL

THE INFORMATION CONTAINED IN THIS DRAWING IS THE SOLE PROPERTY OF <INSERT COMPANY NAME HERE>. ANY REPRODUCTION IN PART OR AS A WHOLE WITHOUT THE WRITTEN PERMISSION OF <INSERT COMPANY NAME HERE> IS PROHIBITED.

		UNLESS OTHERWISE SPECIFIED:		NAME	DATE	TITLE:	
		DIMENSIONS ARE IN INCHES		DRAWN			
		TOLERANCES:		CHECKED			
		FRACTIONAL $\pm$		ENG APPR.			
		ANGULAR: MACH $\pm$ BEND $\pm$		MFG APPR.			
		TWO PLACE DECIMAL $\pm$		Q.A.		<div>SIZE</div> <div>DWG. NO.</div> <div>REV</div>	
		THREE PLACE DECIMAL $\pm$		COMMENTS:			
		INTERPRET GEOMETRIC TOLERANCING PER:					
		MATERIAL				<div>A</div> <div>ASC175-200</div>	
		FINISH					
NEXT ASSY	USED ON					SCALE: 1:5	WEIGHT:
APPLICATION		DO NOT SCALE DRAWING				SHEET 1 OF 1	